

QRHA12

60.5~91.9GHz, WR-12

Features:
* Broadband

Applications:
* Wireless
* Transceiver
* Laboratory Test
* Broadcast

Electrical

Frequency: 60.5~91.9GHz
Gain: 15, 20, 25dB
VSWR: 1.3 max.

Mechanical

Interface: WR-12
Flange: UG387/U
Material: Brass

How To Order

QRHA12-15 - 15dB, Outline A

QRHA12-20 - 20dB, Outline B

QRHA12-25 - 25dB, Outline C

Customization is available upon request.

Outline Drawings

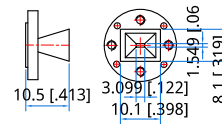

Outline A

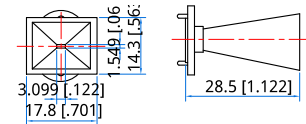

Outline B

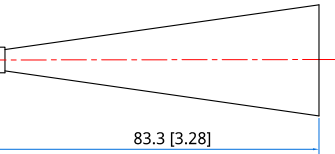
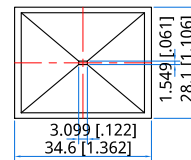

Outline C

Unit: mm [in]
Tolerance: $\pm 0.2\text{mm}$ [$\pm 0.008\text{in}$]